

# Pavement Preservation

## Concrete Patching Example

STANDARD PLANS TO BE USED ON THIS PROJECT

STANDARD	REV. DATE
CP-01	06-26-01
EC-01	10-01-05
PM-01	01-21-98

STATE OF LOUISIANA  
DEPARTMENT OF TRANSPORTATION

PLANS OF PROPOSED  
**STATE HIGHWAY**  
F.A.P. NO. 3707(512)  
STATE PROJECT NO. 837-17-0010  
THOMAS ROAD (JCT LA 34 - GLENWOOD DR.)  
OUACHITA PARISH  
LA 617

C.S. LOG MILE 1.662  
STA. 104+75  
END. S.P. 837-17-0010

C.S. LOG MILE 0.000  
STA. 17+00  
BEG. S.P. 837-17-0010

TRAFFIC DATA  
2006 A.D.T. • 25,100  
2018 A.D.T. • 26,900  
D • 55%  
K • 10%  
T • 7%

TYPE OF CONSTRUCTION:  
FULL DEPTH PATCHING OF JOINTED CONCRETE PAVEMENT.  
CURB REPAIR AND CATCH BASIN & MANHOLE ADJUSTMENTS.

NO.	DATE	BY	REVISION
1	2-9-10	Shts 1 & 32-32a	2 P.L.S. 2-7-10 LL

RECOMMENDED FOR APPROVAL

*[Signature]*  
PROGRAM DELIVERY/DESIGN ENGINEER

*[Signature]*  
DISTRICT ADMINISTRATOR

*[Signature]*  
CHIEF ENGINEER

11-3-09  
DATE

PAUL E. COLQUETTE  
REG. NO. 19948  
REGISTERED PROFESSIONAL ENGINEER  
IN  
CIVIL ENGINEERING

THE 2006 LOUISIANA DOTD STANDARD SPECIFICATIONS FOR ROADS AND BRIDGES, AS AMENDED BY THE PROJECT SPECIFICATIONS, SHALL GOVERN ON THIS PROJECT.

NO.	DATE	BY	REVISION
1			

**INDEX TO SHEETS**

1	TITLE SHEET
2	INDEX TO SHEETS
3	LIMITS OF PROJECT
4-5	GENERAL AND CONSTRUCTION NOTES
8-12	TYPICAL SECTIONS & DETAILS
13-31	SUMMARY SHEETS
32	SUMMARY OF ESTIMATED QUANTITIES
33-36	TRAFFIC CONTROL & SIGNING DETAILS

NO.	DATE	BY	REVISION
1			

INDEX TO SHEETS

OUACHITA  
LA 617-0010

INDEX TO SHEETS

CONTRACT NO. 837-17-0010

# Pavement Preservation

## Concrete Patching Example

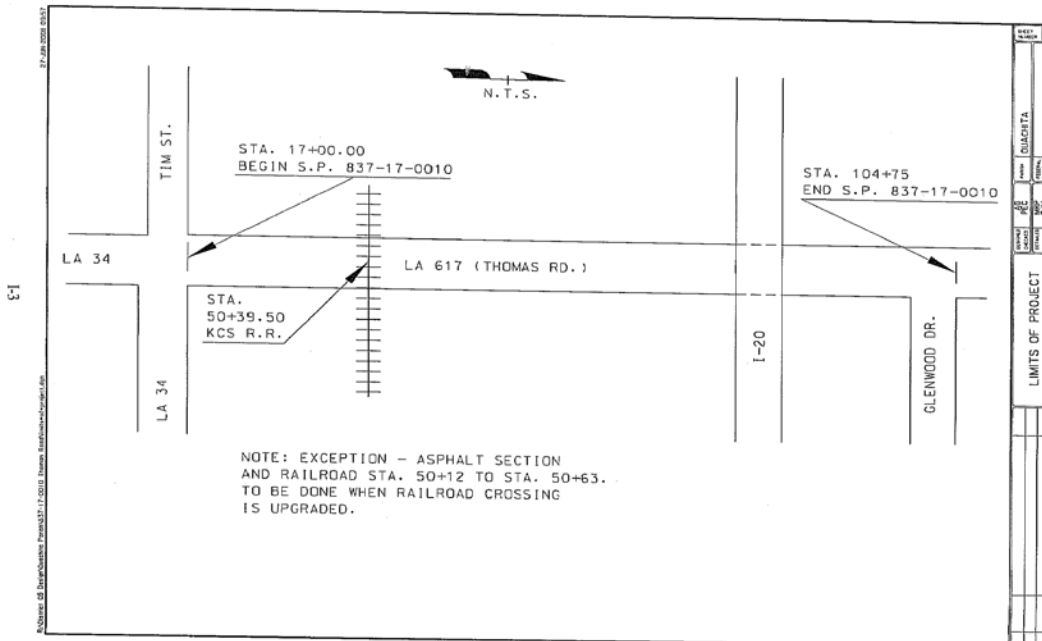

Cleaning and Resealing Existing Transverse Joints (CPR-01) – Found on the DOTD Standard Plans / Special Details website

**FULL DEPTH PATCHING OF JOINTED CONCRETE PAVEMENT (8" THICK)**

STATION	DESCRIPTION	LENGTH (FL)	WIDTH (FL)	602-05-01120	602-06-02120	602-05-03120
				16.0 SQUARE YARDS AND UNDER	16.1 SQUARE YARDS TO 48.0 SQUARE YARDS	48.1 SQUARE YARDS AND OVER
				SQ. YD.	SQ. YD.	SQ. YD.
21+40	MEDIAN	6	6.0	4.0		
54+50	MEDIAN	6	8.0	5.3		
65+00	MEDIAN	6	16.5	11.0		
73+90	MEDIAN	6	8.0	5.3		
103+10	MEDIAN	13	11.0	15.9		
104+20	MEDIAN	6	14.0	9.3		
21+70	NBIL	11	12.0	14.7		
24+50	NBIL	6	12.0	8.0		
34+20	NBIL	44	12.0			58.7
37+30	NBIL	5	12.0	8.0		
38+50	NBIL	6	12.0	8.0		
42+48	NBIL	61	12.0			81.3
45+90	NBIL	5	12.0	8.0		
50+70	NBIL	9	12.0	10.7		
50+85	NBIL	21	12.0		28.0	
52+90	NBIL	5	12.0	8.0		
58+90	NBIL	5	12.0	8.0		
60+85	NBIL	5	12.0	8.0		
62+51	NBIL	6	12.0	8.0		
62+89	NBIL	6	12.0	8.0		
<b>SUB-TOTALS</b>				<b>148.2</b>	<b>28.0</b>	<b>140.0</b>

STREET NUMBER: 13  
 PROJECT: 837-17-0010  
 DISTRICT OVERSEER: [Signature]

# Pavement Preservation

## Concrete Patching Example

L-6

FULL DEPTH PATCHING OF JOINTED CONCRETE PAVEMENT (8" THICK)						
STATION	DESCRIPTION	LENGTH (Ft.)	WIDTH (Ft.)	502-05-01120	602-05-02120	602-05-03120
				15.0 SQUARE YARDS AND UNDER	16.1 SQUARE YARDS TO 48.0 SQUARE YARDS	48.1 SQUARE YARDS AND OVER
				SQ. YD.	SQ. YD.	SQ. YD.
65+30	NBIL	6	12.0	8.0		
67+60	NBIL	6	12.0	8.0		
68+80	NBIL	20	12.0		26.7	
70+40	NBIL	40	12.0			53.3
71+20	NBIL	8	12.0	10.7		
73+50	NBIL	6	12.0	8.0		
74+40	NBIL	110	12.0	16.0		146.7
75+16	NBIL	6	12.0	8.0		
75+25	NBIL	18	12.0		24.0	
82+15	NBIL	16	13.0		23.1	
82+55	NBIL	6	13.0	8.7		
85+12	NBIL	20	13.0		28.9	
91+13	NBIL	6	12.0	8.0		
91+04	NBIL	6	12.0	8.0		
92+28	NBIL	6	12.0	8.0		
92+92	NBIL	6	12.0	8.0		
94+52	NBIL	6	12.0	8.0		
95+41	NBIL	6	12.0	8.0		
92+92	NBLTL	6	11.0	7.3		
94+12	NBLTL	6	13.0	8.7		
SUB-TOTALS				131.4	102.7	200.0

SHEET NUMBER		14
PROJECT NUMBER	PROJECT	0408214
	DATE	08/17/2010
SHEET TITLE	CONTRACT	0408214
	DATE	08/17/2010
DRAWN BY	DATE	
	DATE	
CHECKED BY	DATE	
	DATE	
 PAVEMENT PATCHING TABLE SHEET 14 OF 15		
 CONTRACT # 0408214		

L-7

FULL DEPTH PATCHING OF JOINTED CONCRETE PAVEMENT (8" THICK)						
STATION	DESCRIPTION	LENGTH (Ft.)	WIDTH (Ft.)	502-05-01120	602-05-02120	602-05-03120
				16.0 SQUARE YARDS AND UNDER	16.1 SQUARE YARDS TO 48.0 SQUARE YARDS	48.1 SQUARE YARDS AND OVER
				SQ. YD.	SQ. YD.	SQ. YD.
16+53	NBCL	107	14.0			166.4
21+00	NBCL	261	14.0			406.0
22+06	NBCL	14	14.0		21.8	
24+20	NBCL	34	14.0			52.9
26+00	NBCL	200	14.0			311.1
29+00	NBCL	292	14.0			454.2
31+50	NBCL	51	14.0			79.3
32+42	NBCL	18	14.0		28.0	
33+97	NBCL	6	14.0	9.3		
35+80	NBCL	37	14.0			57.6
36+25	NBCL	36	14.0			56.0
37+10	NBCL	26	14.0		40.4	
37+30	NBCL	6	14.0	9.3		
38+50	NBCL	6	14.0	9.3		
38+74	NBCL	6	14.0	9.3		
40+15	NBCL	6	14.0	9.3		
42+06	NBOL	10	14.0	15.6		
42+48	NBOL	61	14.0			94.9
44+35	NBOL	21	14.0		32.7	
45+15	NBOL	31	14.0			48.2
45+80	NBOL	6	14.0	9.3		
46+00	NBOL	6	14.0	9.3		
46+90	NBOL	38	14.0			59.1
SUB-TOTALS				60.7	122.9	1,765.7

SHEET NUMBER		15
PROJECT NUMBER	PROJECT	0408214
	DATE	08/17/2010
SHEET TITLE	CONTRACT	0408214
	DATE	08/17/2010
DRAWN BY	DATE	
	DATE	
CHECKED BY	DATE	
	DATE	
 PAVEMENT PATCHING TABLE SHEET 15 OF 15		
 CONTRACT # 0408214		

# Pavement Preservation

## Concrete Patching Example

FULL DEPTH PATCHING OF JOINTED CONCRETE PAVEMENT (8" THICK)						
STATION	DESCRIPTION	LENGTH (FT.)	WIDTH (FT.)	602-05-01120	602-05-02120	602-05-03120
				16.0 SQUARE YARDS AND UNDER	16.1 SQUARE YARDS TO 48.0 SQUARE YARDS	48.1 SQUARE YARDS AND OVER
				SQ. YD.	SQ. YD.	SQ. YD.
50+70	NBOL	6	14.0	9.3		
50+85	NBOL	21	14.0		32.7	
51+53	NBOL	6	14.0	9.3		
51+84	NBOL	6	14.0	9.3		
52+70	NBOL	6	14.0	9.3		
54+60	NBOL	46	14.0			71.6
55+10	NBOL	12	14.0		18.7	
55+60	NBOL	33	14.0			51.3
55+95	NBOL	6	14.0	9.3		
56+20	NBOL	6	14.0	9.3		
57+45	NBOL	17	14.0		26.4	
58+20	NBOL	39	14.0		43.6	
58+40	NBOL	28	14.0			60.7
58+50	NBOL	6	14.0	9.3		
58+80	NBOL	6	14.0	9.3		
59+00	NBOL	26	14.0		40.4	
59+80	NBOL	9	14.0	14.0		
60+10	NBOL	6	14.0	9.3		
60+50	NBOL	11	14.0		17.1	
60+80	NBOL	6	14.0	9.3		
61+40	NBOL	9	14.0	14.0		
61+60	NBOL	6	14.0	9.3		
61+90	NBOL	6	14.0	9.3		
SUB-TOTALS				139.6	178.9	183.6

SHEET NUMBER	16
QUANTITY	
FINISH	
FEDERAL PROJECT	
STATE PROJECT	837-17-0010
MIP RUN	
MIP RUN	
MIP RUN	
CHANGED	
CHANGED	
DATE	
BY	
REVISION DESCRIPTION	
NO.	DATE
PAVEMENT PATCHING TABLE	
SHEET 1 OF 13	
DISTRICT OF COLUMBIA	

FULL DEPTH PATCHING OF JOINTED CONCRETE PAVEMENT (8" THICK)						
STATION	DESCRIPTION	LENGTH (FT.)	WIDTH (FT.)	602-05-01120	602-05-02120	602-05-03120
				16.0 SQUARE YARDS AND UNDER	16.1 SQUARE YARDS TO 48.0 SQUARE YARDS	48.1 SQUARE YARDS AND OVER
				SQ. YD.	SQ. YD.	SQ. YD.
62+58	NBOL	20	14.0			
63+20	NBOL	6	14.0	9.3	31.1	
63+40	NBOL	33	14.0			51.3
64+00	NBOL	32	14.0			49.8
64+50	NBOL	6	14.0	9.3		
65+80	NBOL	7	14.0	10.9		
66+10	NBOL	12	14.0		18.7	
67+58	NBOL	42	14.0			65.3
68+95	NBOL	6	14.0	9.3		
69+30	NBOL	63	14.0			98.0
70+40	NBOL	6	14.0	9.3		
70+50	NBOL	6	14.0	9.3		
70+80	NBOL	6	14.0	9.3		
71+10	NBOL	6	14.0	9.3		
71+90	NBOL	18	14.0		28.0	
72+50	NBOL	150	14.0			233.3
72+63	NBOL	6	14.0	9.3		
75+25	NBOL	55	14.0			85.6
75+93	NBOL	28	14.0		43.6	
82+15	NBOL	30	12.0		40.0	
91+13	NBOL	6	12.0	8.0		
91+28	NBOL	6	12.0	8.0		
92+52	NBOL	6	12.0	8.0		
93+89	NBOL	6	12.0	8.0		
SUB-TOTALS				117.3	161.4	583.3

SHEET NUMBER	17
QUANTITY	
FINISH	
FEDERAL PROJECT	
STATE PROJECT	837-17-0010
MIP RUN	
MIP RUN	
MIP RUN	
CHANGED	
CHANGED	
DATE	
BY	
REVISION DESCRIPTION	
NO.	DATE
PAVEMENT PATCHING TABLE	
SHEET 1 OF 13	
DISTRICT OF COLUMBIA	

# Pavement Preservation

## Concrete Patching Example

FULL DEPTH PATCHING OF JOINTED CONCRETE PAVEMENT (8" THICK)						
STATION	DESCRIPTION	LENGTH (FL.)	WIDTH (FL.)	602-05-01120	602-05-02120	602-05-03120
				16.0 SQUARE YARDS AND UNDER	16.1 SQUARE YARDS TO 48.0 SQUARE YARDS	48.1 SQUARE YARDS AND OVER
				SQ. YD.	SQ. YD.	SQ. YD.
94+52	NBOL	5	12.0	5.0		
95+62	NBOL	6	12.0	8.0		
102+32	NBOL	6	14.0	9.3		
100+24	NBRT	5	14.0	9.3		
101+44	NBRT	5	14.0	9.3		
102+32	NBRT	6	14.0	9.3		
103+55	NBRT	14	14.0		21.8	
104+15	NBRT	8	12.0	10.7		
92+84	NBRTL	5	12.0	8.0		
94+30	NBRTL	5	12.0	8.0		
94+52	NBRTL	5	12.0	8.0		
95+11	NBRTL	5	12.0	8.0		
95+31	NBRTL	5	12.0	8.0		
95+93	NBRTL	6	12.0	8.0		
96+53	NBRTL	6	12.0	8.0		
54+72	NBTL	25	16.0		44.4	
55+00	NBTL	6	16.0	10.7		
55+90	NBTL	8.5	6.0	5.7		
57+80	NBTL	8.5	6.0	5.7		
SUB-TOTALS				142.0	66.2	0.0

PROJECT NUMBER	18
QUAD/CITY	
FEDERAL PROJECT	
STATE PROJECT	837-17-0010
LOCAL PROJECT	
DATE	
SHEET	37
DISTRICT OF OREGON	

PAVEMENT PATCHING TABLE  
SHEET 8 OF 13



FULL DEPTH PATCHING OF JOINTED CONCRETE PAVEMENT (8" THICK)						
STATION	DESCRIPTION	LENGTH (FL.)	WIDTH (FL.)	602-05-01120	602-05-02120	602-05-03120
				16.0 SQUARE YARDS AND UNDER	16.1 SQUARE YARDS TO 48.0 SQUARE YARDS	48.1 SQUARE YARDS AND OVER
				SQ. YD.	SQ. YD.	SQ. YD.
99+57	SBEL	6	14.0	9.3		
17+60	SBIL	6	13.0	8.7		
18+03	SBIL	6	13.0	8.7		
18+20	SBIL	7	13.0	10.1		
21+40	SBIL	6	13.0	8.7		
23+00	SBIL	14	12.0		18.7	
24+50	SBIL	13	12.0		17.3	
27+15	SBIL	6	12.0	8.0		
30+60	SBIL	6	12.0	8.0		
31+50	SBIL	27	12.0		36.0	
32+25	SBIL	150	12.0			200.0
34+00	SBIL	45	12.0			60.0
34+80	SBIL	6	12.0	8.0		
36+00	SBIL	216	12.0			288.0
42+53	SBIL	70	12.0			93.3
43+40	SBIL	50	12.0			66.7
43+60	SBIL	25	12.0		37.3	
44+55	SBIL	6	12.0	8.0		
44+80	SBIL	13	12.0		17.3	
45+90	SBIL	5	12.0	8.0		
47+20	SBIL	5	12.0	8.0		
SUB-TOTALS				93.5	126.6	709.0

PROJECT NUMBER	19
QUAD/CITY	
FEDERAL PROJECT	
STATE PROJECT	837-17-0010
LOCAL PROJECT	
DATE	
SHEET	38
DISTRICT OF OREGON	

PAVEMENT PATCHING TABLE  
SHEET 7 OF 13



# Pavement Preservation

## Concrete Patching Example

FULL DEPTH PATCHING OF JOINTED CONCRETE PAVEMENT (8" THICK)						
STATION	DESCRIPTION	LENGTH (FL.)	WIDTH (FL.)	602-05-01120	602-05-02120	602-05-03120
				16.0 SQUARE YARDS AND UNDER	16.1 SQUARE YARDS TO 48.0 SQUARE YARDS	48.1 SQUARE YARDS AND OVER
				SQ. YD.	SQ. YD.	SQ. YD.
50+70	SBIL	6	12.0	8.0		
50+92	SBIL	6	12.0	8.0		
53+05	SBIL	6	12.0	8.0		
55+00	SBIL	6	12.0	8.0		
55+50	SBIL	6	12.0	8.0		
55+60	SBIL	6	12.0	8.0		
56+30	SBIL	40	12.0			
58+50	SBIL	6	12.0	8.0		53.3
59+50	SBIL	16	12.0			
61+70	SBIL	66	12.0		21.3	
63+90	SBIL	75	12.0			88.0
64+70	SBIL	53	12.0			100.0
67+10	SBIL	6	12.0	8.0		70.7
67+80	SBIL	6	12.0	8.0		
68+05	SBIL	12	15.0		20.0	
69+12	SBIL	6	12.0	8.0		
69+50	SBIL	6	12.0	8.0		
73+90	SBIL	13	12.0		17.3	
75+00	SBIL	84	12.0			112.0
78+70	SBIL	6	12.0	8.0		
81+72	SBIL	7	12.0	9.3		
85+15	SBIL	6	12.0	8.0		
85+37	SBIL	6	12.0	8.0		
SUB-TOTALS				121.3	58.6	424.0

SHEET NUMBER	20
PROJECT NUMBER	187-17-0010
DATE	
SCALE	
DESIGNED BY	
CHECKED BY	
IN CHARGE	
APPROVED	
PAVEMENT PATCHING TABLE	SHEET 20 OF 13
DATE	
SCALE	
DESIGNED BY	
CHECKED BY	
IN CHARGE	
APPROVED	

FULL DEPTH PATCHING OF JOINTED CONCRETE PAVEMENT (8" THICK)						
STATION	DESCRIPTION	LENGTH (FL.)	WIDTH (FL.)	602-05-01120	602-05-02120	602-05-03120
				16.0 SQUARE YARDS AND UNDER	16.1 SQUARE YARDS TO 48.0 SQUARE YARDS	48.1 SQUARE YARDS AND OVER
				SQ. YD.	SQ. YD.	SQ. YD.
85+57	SBIL	7	12.0	9.3		
92+42	SBIL	6	12.0	8.0		
92+74	SBIL	6	12.0	8.0		
94+11	SBIL	6	13.0	8.7		
95+59	SBIL	36	13.0			52.0
96+35	SBIL	46	12.0			61.3
99+57	SBIL	9	14.0	14.0		
102+89	SBIL	37	12.0			49.3
104+20	SBIL	6	12.0	8.0		
85+16	SBLTL	6	13.0	8.7		
17+70	SBOL	6	14.0	9.3		
19+10	SBOL	9	13.0	13.0		
20+03	SBOL	15	13.0			
20+20	SBOL	6	13.0	8.7	21.7	
20+35	SBOL	6	13.0	8.7		
20+75	SBOL	6	13.0	8.7		
21+16	SBOL	6	13.0	8.7		
21+40	SBOL	6	13.0	8.7		
22+00	SBOL	18	13.0		26.0	
23+00	SBOL	27	12.0		36.0	
24+50	SBOL	35	13.0			50.6
25+00	SBOL	87	13.0			96.8
SUB-TOTALS				130.5	83.7	310.0

SHEET NUMBER	21
PROJECT NUMBER	187-17-0010
DATE	
SCALE	
DESIGNED BY	
CHECKED BY	
IN CHARGE	
APPROVED	
PAVEMENT PATCHING TABLE	SHEET 21 OF 13
DATE	
SCALE	
DESIGNED BY	
CHECKED BY	
IN CHARGE	
APPROVED	

# Pavement Preservation

## Concrete Patching Example

FULL DEPTH PATCHING OF JOINTED CONCRETE PAVEMENT (8" THICK)						
STATION	DESCRIPTION	LENGTH (FL)	WIDTH (FL)	602-05-01120	602-05-02120	602-05-03120
				16.0 SQUARE YARDS AND UNDER	16.1 SQUARE YARDS TO 48.0 SQUARE YARDS	48.1 SQUARE YARDS AND OVER
				SQ. YD.	SQ. YD.	SQ. YD.
26+30	SBOL	46	13.0			66.4
29+00	SBOL	345	13.0			502.7
31+00	SBOL	100	14.0			155.6
32+50	SBOL	202	14.0			314.2
35+00	SBOL	253	14.0			401.3
37+70	SBOL	6	14.0	9.3		
38+40	SBOL	12	14.0		18.7	
38+75	SBOL	149	14.0			231.8
41+00	SBOL	126	14.0			196.0
42+59	SBOL	117	14.0			182.0
43+80	SBOL	68	14.0			105.8
44+55	SBOL	6	14.0	9.3		
44+80	SBOL	13	14.0		20.2	
45+20	SBOL	20	14.0		31.1	
45+40	SBOL	6	14.0	9.3		
45+60	SBOL	6	14.0	9.3		
46+50	SBOL	43	14.0			65.9
50+70	SBOL	6	14.0	9.3		
50+92	SBOL	6	14.0	9.3		
51+25	SBOL	6	14.0	9.3		
51+35	SBOL	6	14.0	9.3		
SUB-TOTALS				74.4	70.0	2,222.7

SHEET NUMBER	22
DIVISION	QUADRANT
PROJECT	167-17-0010
DATE	
NO.	



PAVEMENT PATCHING TABLE  
SHEET 10 OF 13



CONTRACT 167-17-0010

FULL DEPTH PATCHING OF JOINTED CONCRETE PAVEMENT (8" THICK)						
STATION	DESCRIPTION	LENGTH (FL)	WIDTH (FL)	602-05-01120	602-05-02120	602-05-03120
				16.0 SQUARE YARDS AND UNDER	16.1 SQUARE YARDS TO 48.0 SQUARE YARDS	48.1 SQUARE YARDS AND OVER
				SQ. YD.	SQ. YD.	SQ. YD.
51+55	SBOL	8	14.0	12.4		
51+80	SBOL	15	14.0		23.3	
52+06	SBOL	6	14.0	9.3		
52+16	SBOL	6	14.0	9.3		
52+36	SBOL	6	14.0	9.3		
53+50	SBOL	37	14.0			57.6
54+18	SBOL	6	14.0	9.3		
54+60	SBOL	41	14.0			63.8
56+70	SBOL	234	14.0			364.0
57+40	SBOL	73	14.0			113.6
58+13	SBOL	6	14.0	9.3		
59+70	SBOL	191	14.0			297.1
60+50	SBOL	55	14.0			85.5
61+40	SBOL	90	14.0			140.0
62+20	SBOL	122	14.0			189.8
64+20	SBOL	26	14.0		40.4	
64+80	SBOL	106	14.0			164.9
66+80	SBOL	6	14.0	9.3		
67+00	SBOL	6	14.0	9.3		
67+45	SBOL	6	14.0	9.3		
67+80	SBOL	6	14.0	9.3		
68+40	SBOL	53	14.0			82.4
68+80	SBOL	22	14.0		34.2	
69+30	SBOL	28	14.0		43.6	
SUB-TOTALS				96.1	141.5	1,558.8

SHEET NUMBER	23
DIVISION	QUADRANT
PROJECT	167-17-0010
DATE	
NO.	



PAVEMENT PATCHING TABLE  
SHEET 11 OF 13



CONTRACT 167-17-0010

# Pavement Preservation

## Concrete Patching Example

FULL DEPTH PATCHING OF JOINTED CONCRETE PAVEMENT (8" THICK)						
STATION	DESCRIPTION	LENGTH (FL.)	WIDTH (FL.)	602-05-01120	602-05-02120	602-05-03120
				16.0 SQUARE YARDS AND UNDER	16.1 SQUARE YARDS TO 48.0 SQUARE YARDS	48.1 SQUARE YARDS AND OVER
				SQ. YD.	SQ. YD.	SQ. YD.
69+90	SBOL	6	14.0	9.3		
70+40	SBOL	22	14.0		34.2	
70+90	SBOL	88	14.0			105.8
72+50	SBOL	86	14.0			133.8
73+90	SBOL	11	14.0		17.1	
74+50	SBOL	75	14.0			116.7
75+00	SBOL	36	14.0			56.0
75+90	SBOL	19	14.0		29.6	
76+10	SBOL	13	14.0		20.2	
76+40	SBOL	33	14.0			51.3
76+90	SBOL	14	14.0		21.0	
77+25	SBOL	6	12.0	8.0		
77+35	SBOL	6	12.0	8.0		
78+49	SBOL	12	14.0		18.7	
78+70	SBOL	6	14.0	9.3		
79+77	SBOL	10	14.0	15.6		
80+23	SBOL	13	12.0		17.3	
85+16	SBOL	13	12.0		17.3	
85+37	SBOL	6	12.0	8.0		
85+57	SBOL	7	12.0	9.3		
85+85	SBOL	6	12.0	8.0		
92+42	SBOL	6	12.0	8.0		
94+11	SBOL	6	12.0	8.0		
94+52	SBOL	6	12.0	8.0		
SUB-TOTALS				99.5	176.2	463.6

SHEET NUMBER 24

QUANTITY

MPR FLAR FEDERAL PROJECT 037-17-0010

MPR FLAR STATE PROJECT

DATE SHEET

DATE SHEET

REVISION DESCRIPTION

DATE



PAVEMENT PATCHING TABLE

SHEET 12 OF 13



DISTRICT OF DESIGN

FULL DEPTH PATCHING OF JOINTED CONCRETE PAVEMENT (8" THICK)						
STATION	DESCRIPTION	LENGTH (FL.)	WIDTH (FL.)	602-05-01120	602-05-02120	602-05-03120
				16.0 SQUARE YARDS AND UNDER	16.1 SQUARE YARDS TO 48.0 SQUARE YARDS	48.1 SQUARE YARDS AND OVER
				SQ. YD.	SQ. YD.	SQ. YD.
95+59	SBOL	32	12.0		42.7	
96+38	SBOL	42	12.0			56.0
97+92	SBOL	6	12.0	8.0		
99+70	SBOL	6	12.0	8.0		
104+20	SBOL	6	14.0	9.3		
85+16	SBRTL	6	12.0	8.0		
19+30	SBTL	6	13.0	8.7		
69+20	SBTL	6	17.0	11.3		
78+70	SBTL	6	13.5	9.0		
92+42	SBTL	6	13.5	9.0		
92+64	SBTL	6	12.0	8.0		
97+50	X-OVER	28	12.0		37.3	
SUB-TOTALS				79.3	80.0	55.0
TOTALS				1,453.8	1,366.7	8,635.7

SHEET NUMBER 25

QUANTITY

MPR FLAR FEDERAL PROJECT 037-17-0010

MPR FLAR STATE PROJECT

DATE SHEET

DATE SHEET

REVISION DESCRIPTION

DATE



PAVEMENT PATCHING TABLE

SHEET 13 OF 15



DISTRICT OF DESIGN



# Pavement Preservation

## Concrete Patching Example

ADJUSTING MANHOLES			702-04-00100
STATION	SIDE OF CENTERLINE	ADJUSTING MANHOLES	EACH
		22+85	
29+94	LT.	1	
53+05	LT.	1	
57+18	LT.	1	
60+70	RT.	1	
TOTAL			5

SHEET NUMBER 26	
QUACHITA	837-17-0010
AG	PRINITY
PER	FEDERAL
BNP	STATE
TRK	PROJECT
DISBURSE	DATE
CHARGE	BY
ISSUED	REVISIONS/REVISION
DATE	BY
	
SUMMARY SHEET	
	
DISTRICT 65 DESIGN	

ADJUSTING CATCH BASINS			702-04-00200
STATION	SIDE OF CENTERLINE	ADJUSTING CATCH BASINS	EACH
		20+00	
22+00	LEFT	1	
23+85	LEFT	1	
26+45	LEFT	1	
29+20	LEFT	1	
31+30	LEFT	1	
46+70	LEFT	1	
52+16	LEFT	1	
55+70	RIGHT	1	
58+10	LEFT	1	
65+67	RIGHT	1	
74+27	RIGHT	1	
74+75	LEFT	1	
76+60	LEFT	1	
78+30	LEFT	1	
79+48	LEFT	1	
99+20	RIGHT	1	
101+92	LEFT	1	
TOTAL			18

SHEET NUMBER 27	
QUACHITA	837-17-0010
AG	PRINITY
PER	FEDERAL
BNP	STATE
TRK	PROJECT
DISBURSE	DATE
CHARGE	BY
ISSUED	REVISIONS/REVISION
DATE	BY
	
SUMMARY SHEET	
	
DISTRICT 65 DESIGN	

# Pavement Preservation

## Concrete Patching Example

REMOVAL OF CURBS (CONCRETE)				
STATION	STATION	SIDE C/L	202-02-06140	TYPE
			LIN. FT.	
13+74.5	14+29.5	LT	55.0	MOUNTABLE
31+91	32+09	LT	18.0	BARRIER
32+00	32+33	RT	33.0	MOUNTABLE
35+10	35+35	RT	25.0	BARRIER
36+67	36+76	RT	9.0	MOUNTABLE
48+18	48+42	LT	24.0	MOUNTABLE
49+21	49+49	LT	28.0	MOUNTABLE
49+75	50+05	LT	30.0	MOUNTABLE
51+95.5	52+04.5	LT	9.0	MOUNTABLE
52+07	52+37	LT	30.0	MOUNTABLE
52+75.5	53+04.5	LT	29.0	MOUNTABLE
53+24	53+55	LT	32.0	MOUNTABLE
53+96.5	54+23.5	LT	27.0	MOUNTABLE
54+40	54+65	RT	25.0	MOUNTABLE
54+44.5	54+55.5	LT	11.0	MOUNTABLE
62+65	62+90	RT	5.0	MOUNTABLE
63+22.5	63+27.5	RT	5.0	BARRIER
65+66.5	65+93.5	RT	7.0	BARRIER
66+35	66+48	RT	13.0	MOUNTABLE
67+05	67+40	RT	35.0	MOUNTABLE
69+72	70+08	RT	36.0	BARRIER
69+66.5	70+11.5	LT	23.0	MOUNTABLE
70+08	70+40	RT	32.0	MOUNTABLE
71+04	71+44	RT	40.0	MOUNTABLE
71+22	71+59	LT	36.0	MOUNTABLE
71+54	71+89	RT	35.0	MOUNTABLE
72+02	72+46	RT	44.0	MOUNTABLE
72+58	72+86	RT	28.0	MOUNTABLE
SUB-TOTAL			724.0	

SHEET NUMBER	20
QUAD/CITY	
PARRISH FEDERAL PROJECT STATE PRODUCT	
SUMMARY SHEET	
DISTRICT 05 DESIGN	
A.C.	
INCHES	
FEET	
DATE	
BY	
REVISION/DESCRIPTION	

REMOVAL OF CURBS CONCRETE)				
STATION	STATION	SIDE C/L	202-02-06140	TYPE
			LIN. FT.	
73+09	73+11	LT	2.0	MOUNTABLE
73+13	73+47	LT	34.0	MOUNTABLE
74+00	74+10	LT	10.0	MOUNTABLE
76+51.5	78+55.5	MEDIAN	5.0	MOUNTABLE
79+76	80+66	LT	90.0	BARRIER
79+69.3	79+92.8	MEDIAN	3.5	MOUNTABLE
79+99.5	80+00.5	MEDIAN	1.0	MOUNTABLE
80+20	80+26	MEDIAN	6.0	MOUNTABLE
80+83.8	81+10.3	MEDIAN	32.5	MOUNTABLE
81+63	81+97	MEDIAN	4.0	MOUNTABLE
83+04	83+06	MEDIAN	2.0	MOUNTABLE
96+68	96+84	MEDIAN	16.0	MOUNTABLE
97+53	97+75	MEDIAN	22.0	MOUNTABLE
97+54	98+24	LT	70.0	BARRIER
98+18	98+24	MEDIAN	6.0	MOUNTABLE
98+16.5	98+23.5	MEDIAN	5.0	MOUNTABLE
98+31.3	98+98.8	MEDIAN	67.5	MOUNTABLE
99+45	99+65	MEDIAN	20.0	MOUNTABLE
99+67.5	100+02.5	MEDIAN	35.0	MOUNTABLE
100+15	100+63	LT	48.0	MOUNTABLE
102+09	102+13	LT	4.0	BARRIER
102+95	103+08	LT	13.0	BARRIER
102+99	103+01	LT	2.0	MOUNTABLE
103+53	103+59	LT	6.0	BARRIER
SUB-TOTAL			504.5	
TOTAL			1228.5	

SHEET NUMBER	20
QUAD/CITY	
PARRISH FEDERAL PROJECT STATE PRODUCT	
SUMMARY SHEET	
DISTRICT 05 DESIGN	
A.C.	
INCHES	
FEET	
DATE	
BY	
REVISION/DESCRIPTION	

# Pavement Preservation

## Concrete Patching Example

CONCRETE CURB				
STATION	STATION	SIDE C/L	707-01'00100	TYPE
			LIN. FT.	
13+74.5	14+29.5	LT	55.0	MOUNTABLE
31+91	32+09	LT	18.0	BARRIER
32+00	32+33	RT	33.0	MOUNTABLE
35+10	35+35	RT	25.0	BARRIER
36+67	36+76	RT	9.0	MOUNTABLE
48+18	48+42	LT	24.0	MOUNTABLE
49+21	49+49	LT	28.0	MOUNTABLE
49+75	50+05	LT	30.0	MOUNTABLE
51+95.5	52+04.5	LT	9.0	MOUNTABLE
52+07	52+37	LT	30.0	MOUNTABLE
52+75.5	53+04.5	LT	29.0	MOUNTABLE
53+24	53+56	LT	32.0	MOUNTABLE
53+96.5	54+23.5	LT	27.0	MOUNTABLE
54+40	54+65	RT	25.0	MOUNTABLE
54+44.5	54+55.5	LT	11.0	MOUNTABLE
62+85	62+90	RT	5.0	MOUNTABLE
63+22.5	63+27.5	RT	5.0	BARRIER
64+80	65+27	RT	47.0	BARRIER
65+86.5	65+93.5	RT	7.0	BARRIER
66+35	66+48	RT	13.0	MOUNTABLE
67+05	67+40	RT	35.0	MOUNTABLE
69+72	70+08	RT	36.0	BARRIER
69+86.5	70+11.5	LT	23.0	MOUNTABLE
70+08	70+40	RT	32.0	MOUNTABLE
71+04	71+44	RT	40.0	MOUNTABLE
71+22	71+58	LT	36.0	MOUNTABLE
71+54	71+89	RT	35.0	MOUNTABLE
72+02	72+46	RT	44.0	MOUNTABLE
SUB-TOTAL			743.0	

SHEET NUMBER	30
QUICHTA	602-11-6918
PARRISH FEDERAL PROJECT	
STATE PROJECT	
SUMMARY SHEET	
DISTRICT 06 DESIGN	
A.S. PROJECT	DATE
P.L.C. PROJECT	DATE
DRP PROJECT	DATE
DATE	DATE

CONCRETE CURB				
STATION	STATION	SIDE C/L	707-01'00100	TYPE
			LIN. FT.	
72+58	72+86	RT	28.0	MOUNTABLE
73+09	73+11	LT	2.0	MOUNTABLE
73+13	73+47	LT	34.0	MOUNTABLE
74+00	74+10	LT	10.0	MOUNTABLE
78+51.5	78+56.5	MEDIAN	5.0	MOUNTABLE
79+76	80+66	LT	90.0	BARRIER
79+89.3	79+92.8	MEDIAN	3.5	MOUNTABLE
79+99.5	80+00.5	MEDIAN	1.0	MOUNTABLE
80+20	80+28	MEDIAN	6.0	MOUNTABLE
80+83.8	81+16.3	MEDIAN	32.5	MOUNTABLE
81+93	81+97	MEDIAN	4.0	MOUNTABLE
83+04	83+06	MEDIAN	2.0	MOUNTABLE
96+68	96+84	MEDIAN	16.0	MOUNTABLE
97+53	97+75	MEDIAN	22.0	MOUNTABLE
97+54	98+24	LT	70.0	BARRIER
98+18	98+24	MEDIAN	6.0	MOUNTABLE
98+16.5	98+23.5	MEDIAN	5.0	MOUNTABLE
98+31.3	98+98.8	MEDIAN	67.5	MOUNTABLE
99+45	99+85	MEDIAN	20.0	MOUNTABLE
99+67.5	100+02.5	MEDIAN	35.0	MOUNTABLE
100+15	100+63	LT	48.0	MOUNTABLE
102+09	102+13	LT	4.0	BARRIER
102+95	103+08	LT	13.0	BARRIER
102+99	103+01	LT	2.0	MOUNTABLE
103+53	103+59	LT	6.0	BARRIER
SUB-TOTAL			532.5	
TOTAL			1275.5	

SHEET NUMBER	31
QUICHTA	831-17-0818
PARRISH FEDERAL PROJECT	
STATE PROJECT	
SUMMARY SHEET	
DISTRICT 06 DESIGN	
A.S. PROJECT	DATE
P.L.C. PROJECT	DATE
DRP PROJECT	DATE
DATE	DATE

# Pavement Preservation

## Concrete Patching Example

2/9/2010

**Summary Of Estimated Quantities**

Page: 32

Proposal ID: 837-17-0010      State Project Number: 837-17-0010  
 Federal Project Number: 3707(512)  
 Proposal Description: THOMAS RD (JCT LA 34 - GLENWOOD DR)

Item No.	Description	Supplemental Description	Alternate		Quantity	Units
			Set	Member		
General Items						
202-02-06140	Removal of Curbs (Concrete)				1,228.500	LNFT
602-02-00200	Cleaning and Resealing Existing Longitudinal Pavement Joints				26,325.000	LNFT
602-02-00300	Cleaning and Resealing Existing Transverse Pavements Joints				22,815.000	LNFT
602-05-01120	Full Depth Patching of Jointed Concrete Pavement (16.0 square yards and under) (8" Thick)				1,453.500	SQYD
602-05-02120	Full Depth Patching of Jointed Concrete Pavement (16.1 square yards to 48.0 square yards) (8" Thick)				1,396.700	SQYD
602-05-03120	Full Depth Patching of Jointed Concrete Pavement (48.1 square yards and over) (8" Thick)				6,535.700	SQYD
702-04-00100	Adjusting Manholes				5.000	EACH
702-04-00200	Adjusting Catch Basins				18.000	EACH
707-01-00100	Concrete Curb				1,275.500	LNFT
713-01-00100	Temporary Signs and Barricades				1.000	LUMP
727-01-00100	Mobilization				1.000	LUMP
731-02-00100	ReflectORIZED Raised Pavement Markers				4,792.000	EACH
732-01-01040	Plastic Pavement Striping (8" Width) (Thermoplastic 90 mil)				1,210.000	LNFT

**Notes:**  
 Rev. 1 - 2/9/2010 - Deleted Item and Added an Item

2/9/2010

**Summary Of Estimated Quantities**

Page: 32 a

Proposal ID: 837-17-0010      State Project Number: 837-17-0010  
 Federal Project Number: 3707(512)  
 Proposal Description: THOMAS RD (JCT LA 34 - GLENWOOD DR)

Item No.	Description	Supplemental Description	Alternate		Quantity	Units
			Set	Member		
732-01-01080	Plastic Pavement Striping (24" Width) (Thermoplastic 90 mil)				300.000	LNFT
732-02-01000	Plastic Pavement Striping (Solid Line) (4" Width) (Thermoplastic 40 mil)				7.159	MILE
732-03-01000	Plastic Pavement Striping (Broken Line) (4" Width) (Thermoplastic 40 mil)				3.973	MILE
732-04-01080	Plastic Pavement Legends and Symbols (Arrow - Left Turn)				11.000	EACH
732-04-15020	Plastic Pavement Legends and Symbols (ONLY)				2.000	EACH
732-04-18000	Plastic Pavement Legends and Symbols (RR Crossing)				4.000	EACH
732-05-00100	Removal of Existing Markings				1.662	MILE
740-01-00100	Construction Layout				1.000	LUMP
NS-713-00001	Dynamic Message Sign Unit				2.000	EACH

**Notes:**  
 Rev. 1 - 2/9/2010 - Deleted Item and Added an Item

# **Pavement Preservation**

## **Concrete Patching Example**

**Temporary Traffic Control Plans (TC-00, TC-06, TC-07, TC-15) – Found on the DOTD Standard Plans / Special Details website**