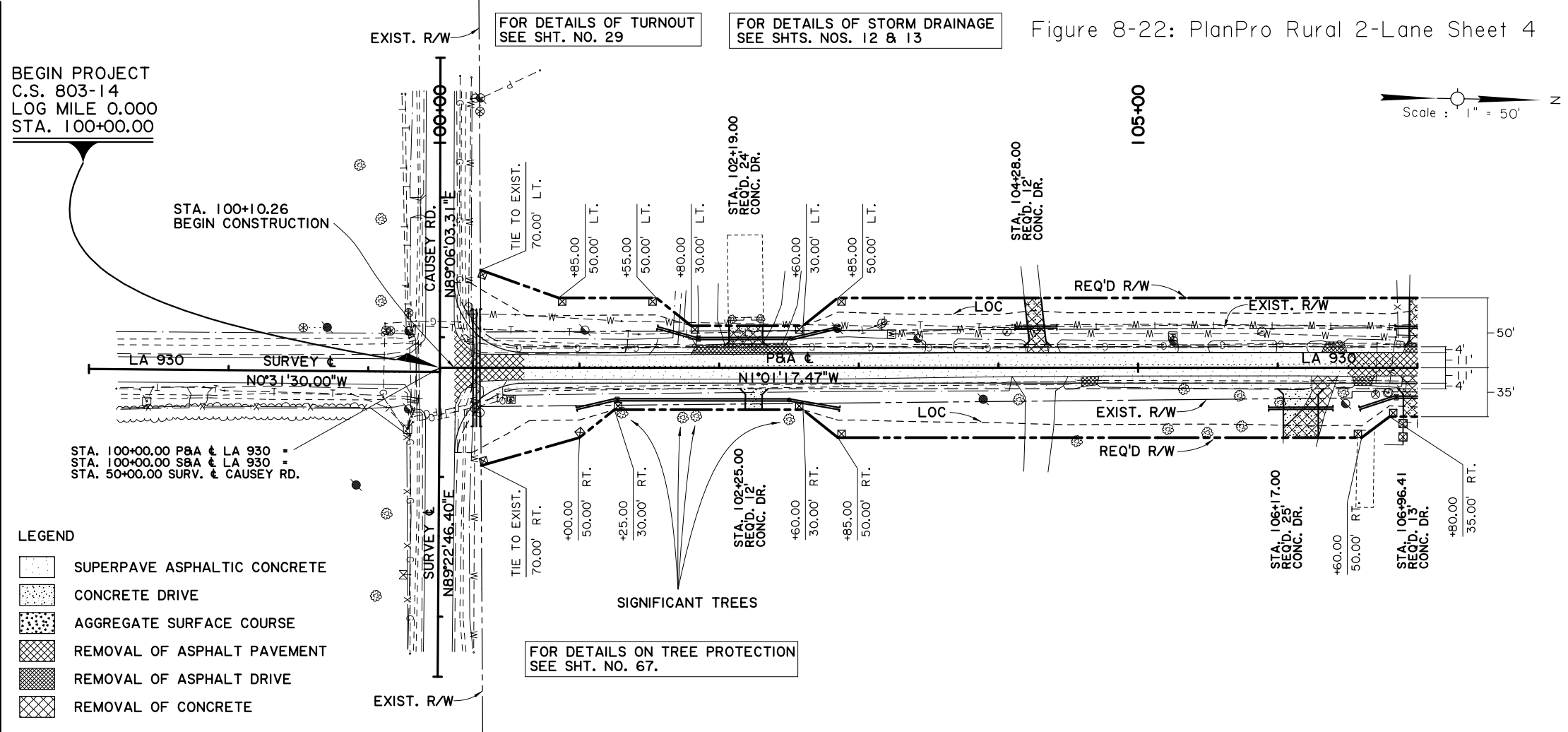

Figure 8-22: PlanPro Rural 2-Lane Sheet 4

LEGEND - EXISTING TOPOGRAPHY

CONTROL POINT	△	GAS LINE	—G—G—
TEMPORARY BENCH MARK	⊠	GAS METER	⊗
PHOTO TARGET	⊗	GAS SERVICE (NO METER)	—G—G—
PAVEMENT EDGE	—	GAS REGULATOR	⊗
SHOULDER EDGE	—	GAS RISER	⊗
SLOPE TOE	—	GAS TEST BOX	⊗
GUARDRAIL TOP	—	GAS VALVE	⊗
HIGH BANK	—	GAS LINE/CASING	—G—G—
WATER'S EDGE	—	GAS VENT	⊗
HIGH WATER MARK	+	RAILROAD MILEPOST	—
BOX CULVERT	—	RAILROAD SIGNAL	—
PIPE CULVERT	—	RAILROAD SWITCH	—
CATCH BASIN TOP (ROUND)	⊕	RAILROAD TRACK	—
DROP INLET TOP (ROUND)	⊕	RR TRAFFIC SIGNAL BOX	—
DRAINAGE MANHOLE TOP	⊕	SEWER LINE	—S—S—
LEVEE TOP	—	SEWER MANHOLE TOP	⊕
DITCH CENTERLINE	—	SEWER BLOWOUT VALVE	⊕
TREE	⊗	SEWER CLEANOUT	⊕
WOODS EDGE	—	SEPTIC TANK	⊕
MARSH LINE	—	SEWER PUMP (PRIVATE)	⊕
SWAMP LINE	—	SEWER TREATMENT (INDIVIDUAL)	⊕
TREE CLUSTER	⊗	FEDERAL AID MARKER	⊕
HEDGE	—	TRAFFIC CONTROLLER BOX	⊕
BUSH	—	TRAFFIC COUNTER	⊕
TREE LINE	—	TRAFFIC SIGNAL	⊕
FENCE LINE	—X—X—	TRAFFIC SIGNAL SUPPORT POLE	⊕
GATE	—	LIGHT POLE	⊕
CATTLE GUARD	—	LIGHT PEDESTAL	⊕
PROPERTY CORNER	⊕	LIGHT POWER VAULT	⊕
RIGHT OF WAY MONUMENT	⊕	TRAFFIC SIGN	⊕
SECTION CORNER	⊕	PARKING METER	⊕
FENCE CORNER	⊕	TELEPHONE POLE	⊕
TELEVISION CABLE	—TV—TV—	TELEPHONE LINE	—T—T—
TELEVISION PEDESTAL	⊕	TELEPHONE BOOTH	⊕
POWER POLE	⊕	TELE CROSS CONNECT BOX	⊕
DEADMAN	⊕	TELEPHONE PEDESTAL	⊕
POWER LINE	—P—P—	TELEPHONE PRESSURE BOX	⊕
POWER JUNCTION BOX	⊕	WATER LINE	—W—W—
POWER VAULT	⊕	WATER LINE/CASING	—W—W—
TRANSFORMER	⊕	WATER CLEANOUT	⊕
COMBINATION POLE	⊕	WATER METER	⊕
POWER DROP	⊕	WATER VALVE	⊕
PIPELINE	—O—O—	WATER VALVE VAULT	⊕
PIPELINE VENT	⊕	FIRE HYDRANT	⊕
PIPELINE REGULATOR	⊕	BILLBOARD	⊕
GAS WELL	⊕	FUEL PUMP	⊕
HAY BALES	—SF—SF—	POST	⊕
SILT FENCE	—SF—SF—	SIGN POST	⊕
INLET SILT TRAP	⊕	STORAGE TANK (ROUND)	⊕
		GRAVE	⊕
		MAILBOX	⊕
		ORNAMENTAL LIGHT	⊕
		FLAG POLE	⊕
		GRAVE	⊕

BEGIN PROJECT
C.S. 803-14
LOG MILE 0.000
STA. 100+00.00



LEGEND

	SUPERPAVE ASPHALTIC CONCRETE
	CONCRETE DRIVE
	AGGREGATE SURFACE COURSE
	REMOVAL OF ASPHALT PAVEMENT
	REMOVAL OF ASPHALT DRIVE
	REMOVAL OF CONCRETE

- ### NOTES:
- FOR REFERENCE POINTS, TBMs AND SURVEYED & ABANDONED ALIGNMENT INFORMATION, SEE SHEETS 1a AND 1b.
 - ALL DRAINAGE STRUCTURES TO BE REMOVED UNLESS OTHERWISE NOTED.
 - AVERAGE DEPTH OF ROADWAY IS LESS THAN 5". ASPHALT ROADWAY AND DRIVES TO BE REMOVED UNDER PAY ITEM 203-01-00100 GENERAL EXCAVATION.

- ### UTILITY COMPANIES:
- Dixie Electric Membership Corporation (225) 262-3045
 - East Ascension Telephone Company, LLC (225) 621-4319
 - Energy (Distribution) (225) 354-3060
 - ASCENSION WATER COMPANY (225) 952-7617
 - COX COMMUNICATIONS (225) 237-5106
 - ATMOS ENERGY CORPORATION (225) 622-2449 ext.209
 - DENBURY RESOURCES (601) 248-3295
 - SOUTHERN NATURAL GAS (205) 352-7403
 - SHELL PIPELINE COMPANY (504) 728-4340

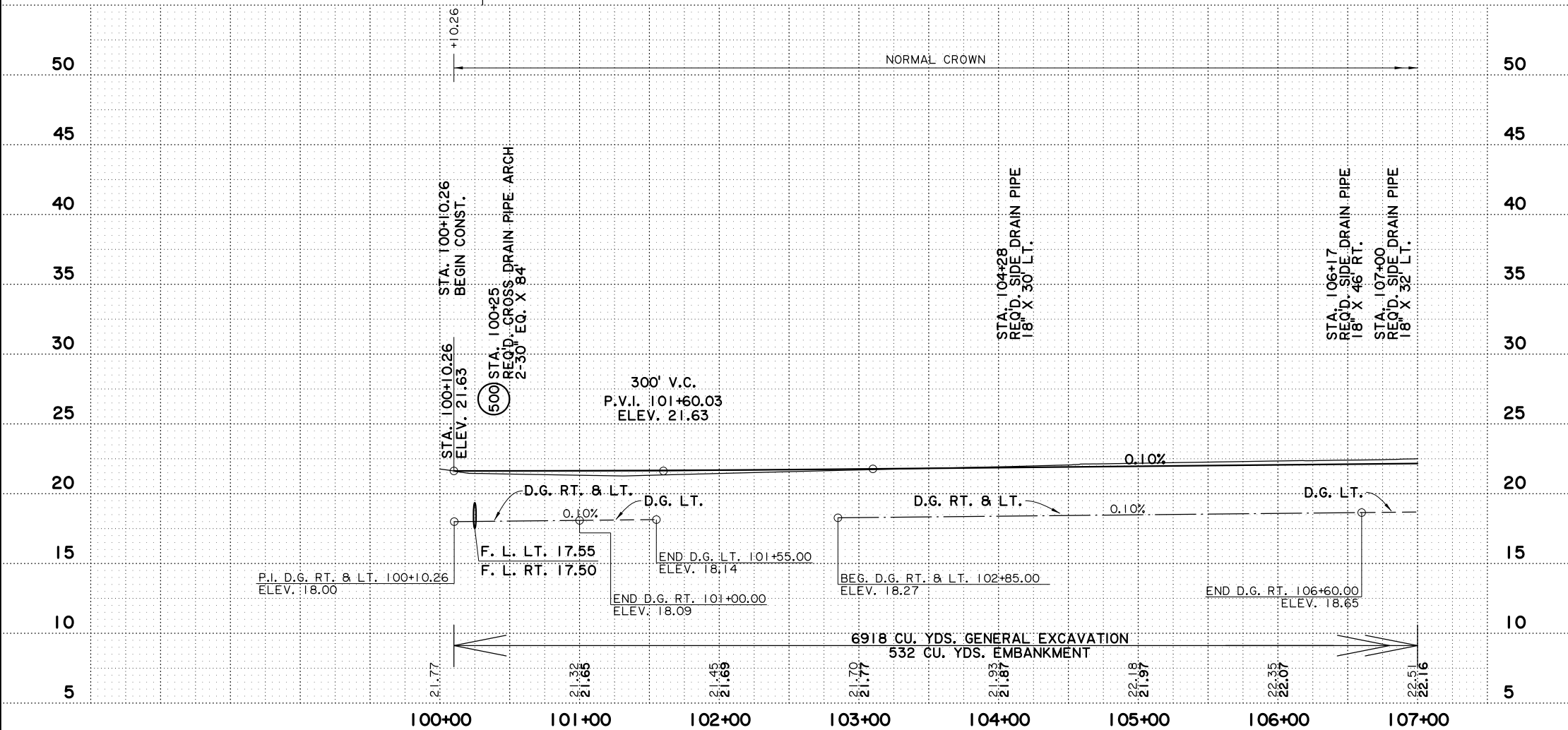

FOR DETAILS OF TURNOUT
SEE SHT. NO. 29

FOR DETAILS OF STORM DRAINAGE
SEE SHTS. NOS. 12 & 13

FOR DETAILS ON TREE PROTECTION
SEE SHT. NO. 67.

