

FOR DETAILS OF DIVERSION SEE SHT. 12

Figure 8-24: PlanPro Rural 2-Lane with Diversion

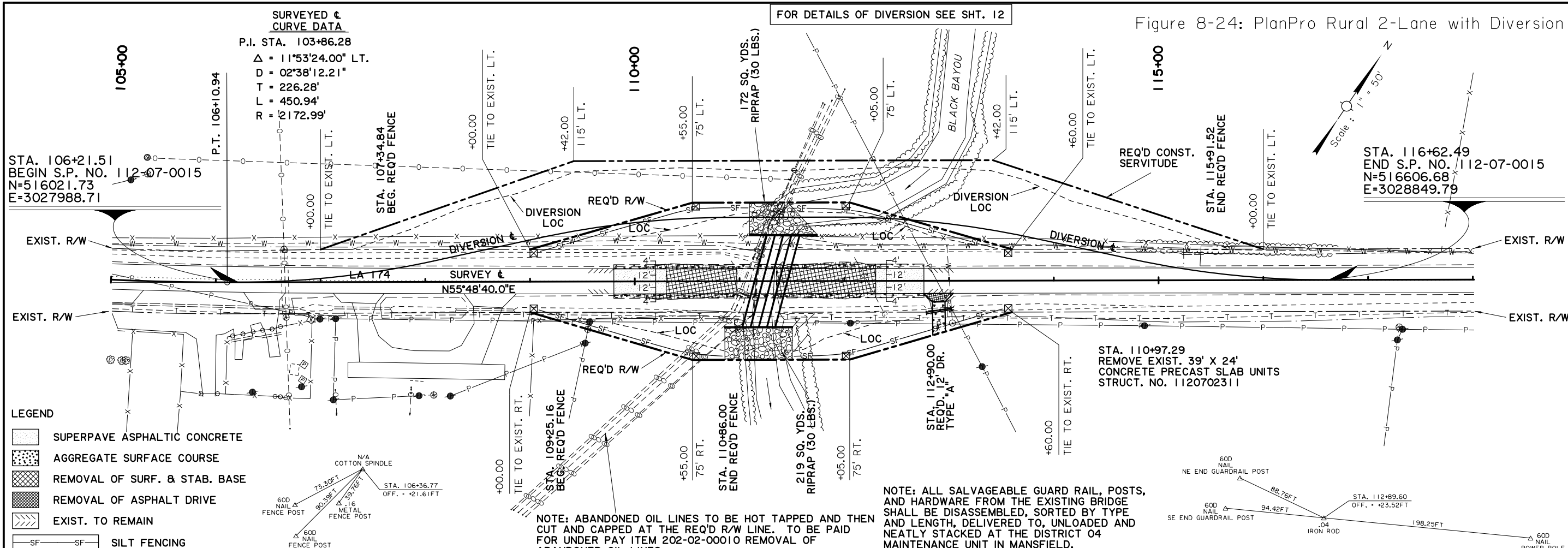

- LEGEND**
- SUPERPAVE ASPHALTIC CONCRETE
 - AGGREGATE SURFACE COURSE
 - REMOVAL OF SURF. & STAB. BASE
 - REMOVAL OF ASPHALT DRIVE
 - EXIST. TO REMAIN
 - SILT FENCING

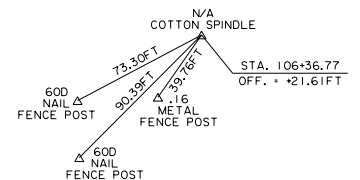

NOTE: ALL SALVAGEABLE GUARD RAIL, POSTS, AND HARDWARE FROM THE EXISTING BRIDGE SHALL BE DISASSEMBLED, SORTED BY TYPE AND LENGTH, DELIVERED TO, UNLOADED AND NEATLY STACKED AT THE DISTRICT 04 MAINTENANCE UNIT IN MANSFIELD.

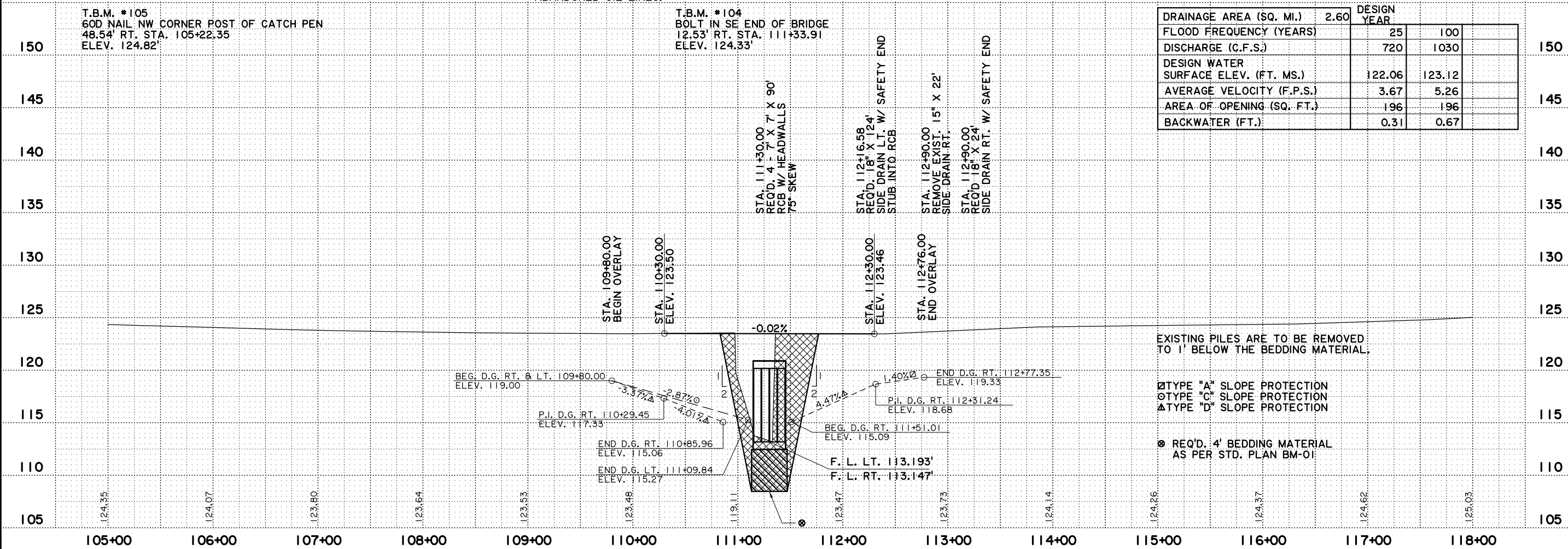
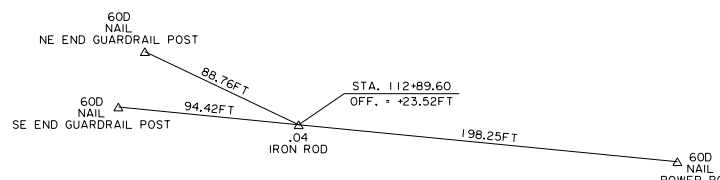

	DRAINAGE AREA (SQ. MI.)	DESIGN YEAR	
		25	100
FLOOD FREQUENCY (YEARS)	2.60	25	100
DISCHARGE (C.F.S.)		720	1030
DESIGN WATER SURFACE ELEV. (FT. MS.)		122.06	123.12
AVERAGE VELOCITY (F.P.S.)		3.67	5.26
AREA OF OPENING (SQ. FT.)		196	196
BACKWATER (FT.)		0.31	0.67

T.B.M. #105
60D NAIL NW CORNER POST OF CATCH PEN
48.54' RT. STA. 105+22.35
ELEV. 124.82'

T.B.M. #104
BOLT IN SE END OF BRIDGE
12.53' RT. STA. 111+33.91
ELEV. 124.33'

SHEET NUMBER 5

PARISH RED RIVER

CONTROL SECTION 112-07

STATE PROJECT H:001812

DESIGNED CHECKED

DETAILED CHECKED

SERIES NUMBER 2 OF 3

BY

REVISION OR CHANGE ORDER DESCRIPTION

NO. DATE

PLAN AND PROFILE SHEET

BLACK BAYOU BRIDGE ON LA 174

ROAD DESIGN